



University  
of London

# St Johns

Lind Street, London, SE8 4JE

**Student  
Homes**

A 4 bedroom mid-terrace house located on a quiet residential street, available for full-time Goldsmiths students looking as a group.

- ❖ A 4 bedroom house with large, bright bedrooms – 1 large double room and 3 medium doubles.
- ❖ The property also features a large kitchen/diner, a living room, a brand new shared bathroom, a separate w/c and a rear garden. The house is neutrally decorated throughout with lots of communal space.
- ❖ Tenancies for the 2018/19 academic year will begin on 9<sup>th</sup> September 2018 and will run through to 5<sup>th</sup> September 2019 (this is a 51 week tenancy).
- ❖ Rent can be split equally and is £158.20 per tenant per week, or can be varied dependent on room size if you'd prefer. We'd suggest – Room 1 (Ground floor, 11.94m<sup>2</sup>) - £155.94 per week, an average monthly rent of £675.74, Room 2 (1<sup>st</sup> floor rear, 11.14m<sup>2</sup>) - £153.18 per week, an average monthly rent of £663.78, Room 3 (1<sup>st</sup> floor mid, 10.62m<sup>2</sup>) - £153.18 per w, an average of £663.78 per month, Room 4 (1<sup>st</sup> floor front, 17.71m<sup>2</sup>) - £170.51 per week, an average monthly rent of £738.88. Utilities (gas, electricity, water), and WIFI are not included in the rent – tenants will need to set up accounts for these.
- ❖ The property is located close to numerous local amenities and transport links. St Johns station is a short 2-3 minute walk away providing easy access to Central London. There are also numerous nearby shops, restaurants and bars in Lewisham and New Cross.
- ❖ Based on you arriving at campus at 9am, your commute time from Lind Street is as follows: 10 minutes via public transport (436, 136 or 21 bus) or an 18 minute walk.

## Photographs:



New bathroom image and floorplan

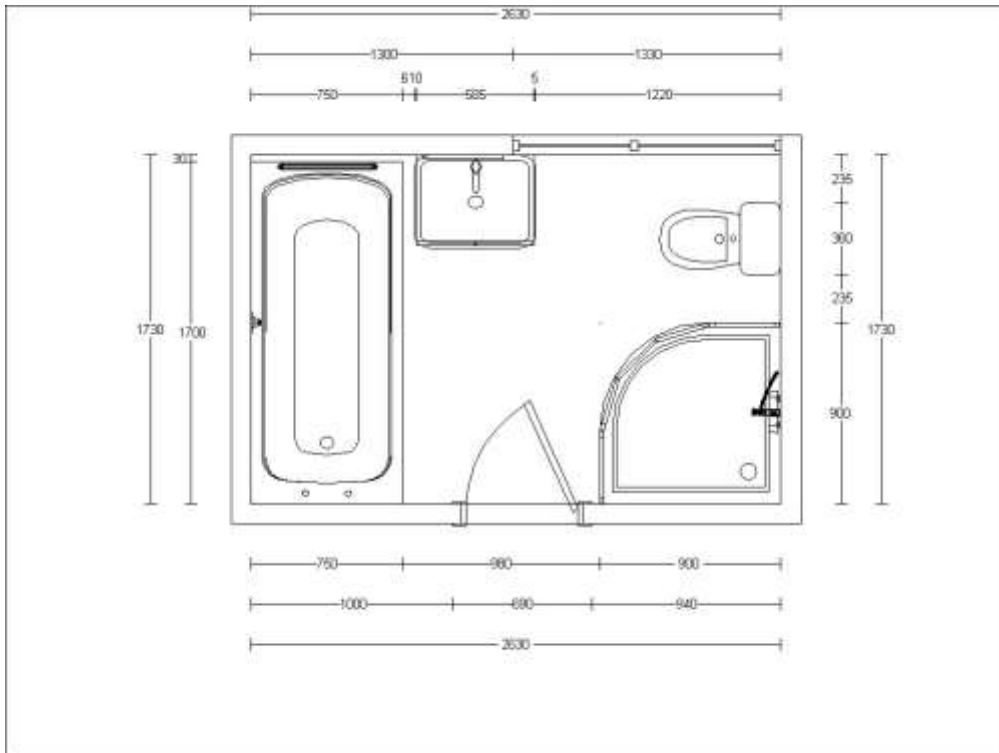

Room 1



Room 2



Room 3



Room 4





## Location:

Click on the map to access an interactive version



## Student Homes Provide:

- ✓ Gas safety inspection certificate.
- ✓ Electrical installation inspection certificate.
- ✓ Energy performance certificate.
- ✓ Keys for the property – a set for each tenant.
- ✓ Peace of mind with out of hours cover, support & advice.
- ✓ Contents Insurance for you during your tenancy – this is in place through Endsleigh, details are on our website & will be provided in our welcome packs.

[Rent a room online](#)